

SO/

VIENNA



ELEVATE

YOUR MEETINGS

There's no such thing as "business as usual" at SO/ Vienna. On the 4th floor, 1,073 sqm of flexible space await - featuring 8 stylish meeting rooms with daylight, modern equipment, and a business lounge. Ideal for meetings, workshops, private events, or even fashion shows.



LE CORBUSIER



Le Corbusier captivates above all with the architecture and a special roof slope, with a ceiling height of 7 m, daylight as well as the possibility to open it and extend it to the foyer.

The room is equipped with a projector, a 5.9 m x 3.3 m screen and a modern Bose sound system.

LE CORBUSIER

Size: 240 sqm

Height: 7 m

Dimensions: 15,5 m x 15,5 m





NIEMEYER & LLOYD WRIGHT

Two light-filled rooms with views of the Danube Canal, equipped with state-of-the-art technology (projector, screen, Bose sound system).

The two flexible meeting rooms, Niemeyer and Lloyd Wright, can be booked separately or combined.

NIEMEYER

Size: 45 sqm

Height: 3,5 m

Dimensions: 7,5 m x 6 m

LLOYD WRIGHT

Size: 44 sqm

Height: 3,5 m

Dimensions: 7,5 m x 6 m



AALTO

The Aalto meeting room is ideal for events for up to 40 people. The room provides optimal daylight through two large glass fronts and is equipped with the latest projector and sound system.

AALTO

Size: 62 sqm

Height: 2,5 m

Dimensions: 8,5 m x 8,5 m





EIFFEL & GARNIER

Eiffel and Garnier are just as captivating as Le Corbusier with their exciting architecture and distinctive roof slopes.

The Garnier room offers views of the winter garden and faces the city center.

The two meeting rooms can be combined or separated by a wall. Both rooms are equipped with state-of-the-art equipment.



EIFFEL

Size: 72 sqm

Height: 3,5 m

Dimensions: 11 m x 6,5 m

GARNIER

Size: 63 sqm

Height: 3,5 m

Dimensions: 11 m x 5,7 m





VAN DER ROHE



Van der Rohe impresses with its exceptional architecture and also offers natural daylight, with sloped ceilings facing the winter garden.

The meeting room can accommodate up to 40 people and is equipped with the latest equipment

VAN DER ROHE

Size: 69 sqm

Height: 3,5 m

Dimensions: 11,5 m x 6 m

BREUER

Breuer is the Oval Office in SO/ Vienna with fixed seating for max. 20 people.

This room is perfect for board meetings with a view of the Danube Canal.

The room is equipped with a modern projector and screen as well as a Bose sound system

BREUER

Size: 76 sqm

Height: 3,5 m

Dimensions: 9,5 m x 8 m



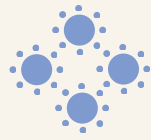

Gala dinner



Theater
without stage

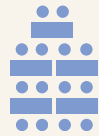

Class room



Board Room



Cabaret



U-Form



closed U

Le Corbusier	130	150	72	-	96	35	-
Breuer	-	-	-	20	-	-	-
Aalto	30	40	24	20	21	20	24
Eiffel	30	40	24	14	12	14	18
Garnier	30	40	24	14	12	14	18
Eiffel & Garnier	60	80	48	-	42	25	30
Niemeyer	20	20	12	12	14	-	-
Llyod Wright	20	20	12	12	14	-	-
Niemeyer & Lloyd Wright	40	50	28	30	32	-	-
Van der Rohe	30	40	24	22	21	18	20



FOYER AND WINTERGARDEN



The 404 sqm foyer is an impressive fusion of modern elegance and artistic sophistication.

With its avant-garde design, sculptural elements and dynamic lighting effects, it creates an inviting atmosphere that immediately immerses guests in the cosmopolitan spirit of the city.

Pipilotti Rist's illuminated ceiling in the winter garden transforms the space into a mesmerizing color play of luminous hues, creating an enchanting environment that transports guests to a world of visual poetry.

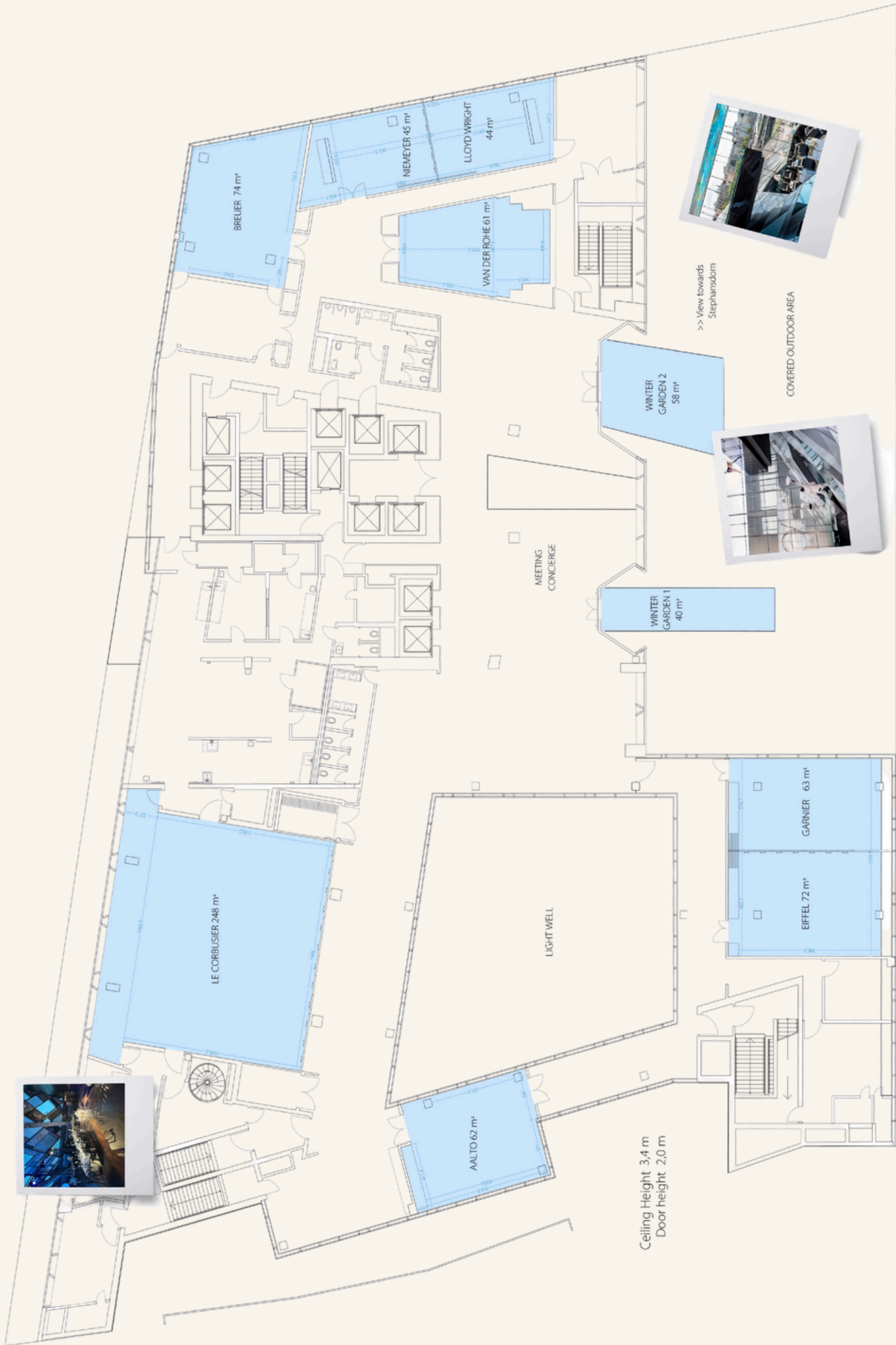

BREUER 74 m²

NIEMEYER 45 m²

LLOYD WRIGHT 44 m²

VAN DER ROHE 61 m²

WINTER GARDEN 2 58 m²

WINTER GARDEN 1 40 m²

LE CORBUSIER 248 m²

AALTO 62 m²

LIGHT WELL

GARNIER 63 m²

EIFFEL 72 m²

MEETING CONCERGE

>> View towards Stephansdom

COVERED OUTDOOR AREA

Ceiling Height 3,4 m
Door height 2,0 m



A FASHION STATEMENT

SO/VIENNA, „The living dreamscape“ by Jean Nouvel, invites you to take a front row seat to avant-garde design by rising stars - right in the very center of the city, the vibrant 2nd district.



HALF DAY PACKAGE

HALF DAY PACKAGE

- Welcome coffee
- Room rental for the main meeting room including conference drinks (mineral water & juices), coffee & tea variations paper & pens
- Projector, screen & 1 flipchart
- Coffee break in the morning OR afternoon with snacks
- Lunch buffet in the foyer
- WIFI on the entire meeting floor





FULL DAY PACKAGE



FULL DAY PACKAGE

- Welcome coffee
- Room rental for the main meeting room including conference drinks (mineral water & juices), coffee & tea variations paper & pens
- Projector, screen & 1 flipchart
- Coffee break in the morning & afternoon with snacks
- Lunch buffet in the foyer
- WIFI on the entire meeting floor

SO/

VIENNA

CONTACTS



JANA KRAKAUER

Groups & Events Sales Manager

jana.krakauer@so-hotels.com

+43 (0) 190 616 8103

SANDRA WIESBAUER

Sales Manager

sandra.wiesbauer@so-hotels.com

+43 (0) 190 616 3104

THOMAS VAN NOORT

Director of Sales, Groups & Events

thomas.vannoort@so-hotels.com

+43 (0) 190616 3100